

REVISION SCHEDULE					
REV. NO.	REV. DESCRIPTION	REV. DATE	DRAWN	CHECKED	
WIP1	WORK IN PROGRESS	09/11/2023	BF	KO'M	
WIP2	WORK IN PROGRESS- BACKGROUND UPDATED	14/12/2023	BF	KO'M	
WIP3	WORK IN PROGRESS	08/04/2024	HB	KO'M	
PL1	ISSUED FOR PLANNING	12/04/2024	FC	KO'M	
PL2	ISSUED FOR PLANNING	24/05/2024	FC	KO'M	

DRAINAGE LEGEND

- Ø100 uPVC CONNECTION FROM NEW UNITS WITH INSPECTION CHAMBER
- AQUACELL SOAKAWAY
- RAIN WATER DOWN PIPE
- Ø100 uPVC CONNECTION FROM NEW UNITS WITH INSPECTION CHAMBER
- Ø150 FOUL SEWER WITH MANHOLE (NEW)
- POP UP
- WATERMAIN (EXISTING) - TO BE CONFIRMED
- Ø100 PE WATERMAIN (NEW)
- Ø25 CONNECTION TO EACH UNIT WITH BOUNDARY BOX
- NEW FIRE HYDRANT
- NEW SLUICE VALVE
- NEW AIR VALVE
- NEW METER
- NEW WASHOUT HYDRANT
- EXISTING UNIT FOOTPRINT
- SITE BOUNDARY
- INTERNAL SITE BOUNDARY - TO BE CONFIRMED

- DRAINAGE NOTES:**
- READ IN CONJUNCTION WITH ALL RELEVANT ARCHITECTS' AND ENGINEERS' DRAWINGS.
 - ALL WATER SERVICES MANHOLES, PIPE MATERIALS AND OTHER FEATURES SHALL COMPLY WITH THE LOCAL AUTHORITY AND IRLISH WATER SERVICES CODES.
 - WHERE COVER TO PIPES IS LESS THAN 1.2M IN ROADS, 1.0M IN PUBLIC AREAS AND 0.8M IN GRASSED/LANDSCAPED AREAS, AND 0.6M IN PRIVATE AREAS, THE COVER SHALL BE 100MM CONCRETE.
 - BACK-FILL TRENCHES IN ROADS WITH MOT STONE COMPACTED IN LAYERS.
 - CLOSE ROAD GULLIES IN THE DIRECTION OF TRAFFIC FLOW.
 - ADJUST FOUNDATION DEPTHS, AS NECESSARY, ADJACENT TO SEWERS TO AVOID UNDERMINING OF THE FOUNDATIONS.
 - DO NOT SET OUT FROM THIS DRAWING. SETTING OUT TO BE DONE FROM ARCHITECTS' DRAWINGS.
 - MANHOLE COVERS AND FRAMES SHALL COMPLY WITH THE LA STANDARD PATTERN WITH MIN OPENING OF 600MM & WITH CLOSED KEYWAYS. HEAVY DUTY TYPE A MANHOLES IN ALL TRAFFICED AREAS AND MEDIUM DUTY TYPE B ELSEWHERE, TO BS EN124. TYPE C MAY BE USED IN ENCLOSED PRIVATE GARDENS.
 - DOUBLE GULLIES, WITH SEPARATE CONNECTIONS TO MAIN, TO BE PROVIDED AT LOW POINTS AND AT THE ENDS OF CUL DE SACS. MAXIMUM RUN OF PIPE 15M. MINIMUM PIPE DIAMETER 150MM. MAXIMUM GULLY SPACING FOR ROADS UP TO 7M WIDE TO BE 50M UNO.
 - MANHOLES ON HOUSE DRAINS TO BE IN PRIVATE PROPERTY. HOUSE DRAINS SHALL NOT PASS THROUGH PROPERTY THEY DO NOT SERVE.
 - RECORD DRAWINGS OF THE AS CONSTRUCTED WORK SHALL BE MADE AVAILABLE TO CORA AT THE END OF THE PROJECT.

- NOTES REGARDING EXISTING PUBLIC SEWERS:**
- CONTRACTOR TO DETERMINE POSITION OF EXISTING SERVICES PRIOR TO ANY EXCAVATION WORK.
 - LEVELS AND LAYOUT OF EXISTING DRAINAGE TO BE CONFIRMED PRIOR TO COMMENCEMENT OF CONSTRUCTION WORK. CONTRACTOR TO ALLOW FOR ANY INVESTIGATION WORK REQUIRED.
 - CONTRACTOR TO ALLOW FOR INVESTIGATION WORK TO LOCATE EXISTING SERVICES AND PROVIDE NEW CONNECTION FROM PROPOSED EXTENSION TO DISCHARGE TO EXISTING WATERMAIN SYSTEM.

WASTEWATER NOTES:

POP UPS, GULLIES AND OTHER FEATURES TO BE COORDINATE WITH PROJECT STAKEHOLDERS. EXTERNAL LANDSCAPING AND FINAL LEVELS TO BE CONFIRMED.

WATER SUPPLY NOTE:

CONTRACTOR TO REFER TO WATER CODE OF PRACTICE AND WATER STANDARD DETAILS FOR INSTALLATION AND REQUIREMENTS OF WATER MAIN COMPONENTS.

<https://www.water.ie/connections/developer-services/standard-details-codes/>

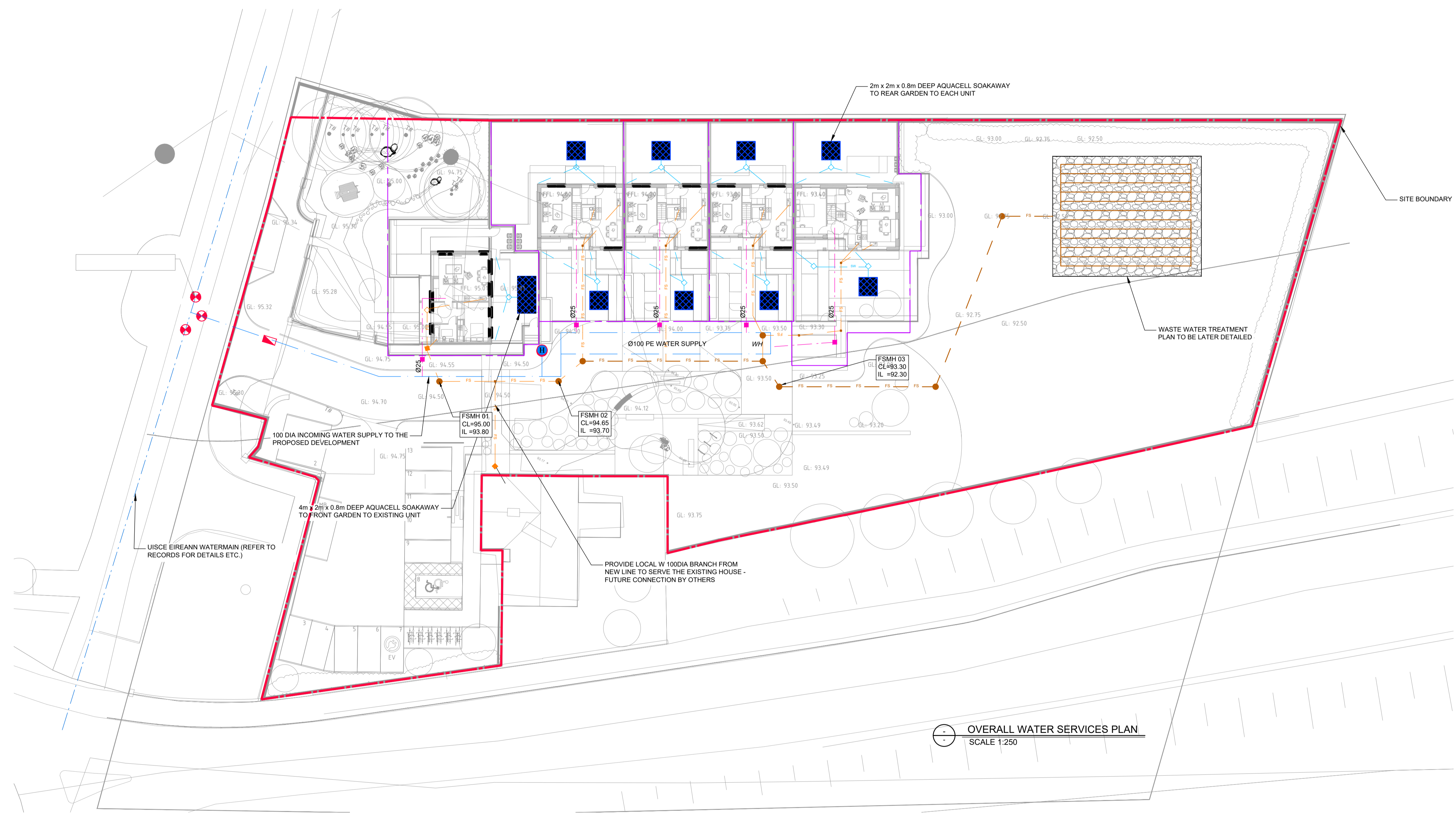

OVERALL WATER SERVICES PLAN
SCALE 1:250

	CARBURY, Co. KILDARE
	DESA

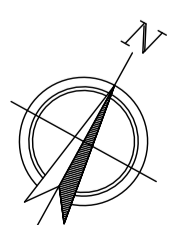

Notes

Drawn by: BF	Checked by: KO'M	Approved by: KO'M	Date: 09/11/2023
Project Name: CARBURY HOUSING		Scale: A.S. @ A1	Project Number: 2316
Drawing Title: PROPOSED WATER SERVICES PLAN	Project: CAR	Originator: CORA	Zone: ZZ

CORA
CONSULTING ENGINEERS

Behan House,
10 Lower Mount Street,
Dublin 2. D02 HT71
Tel: +353 1 661 1100
e-mail: info@cora.ie
Web: www.cora.ie

Level:	Type:	Discipline:	Drawing No:	Stage:	Revision:
00	DR	C	0001	PL	2